

Infitech Standard Bus/Truck Spray Booth

Product: IT-22-6A (Side downdraft)

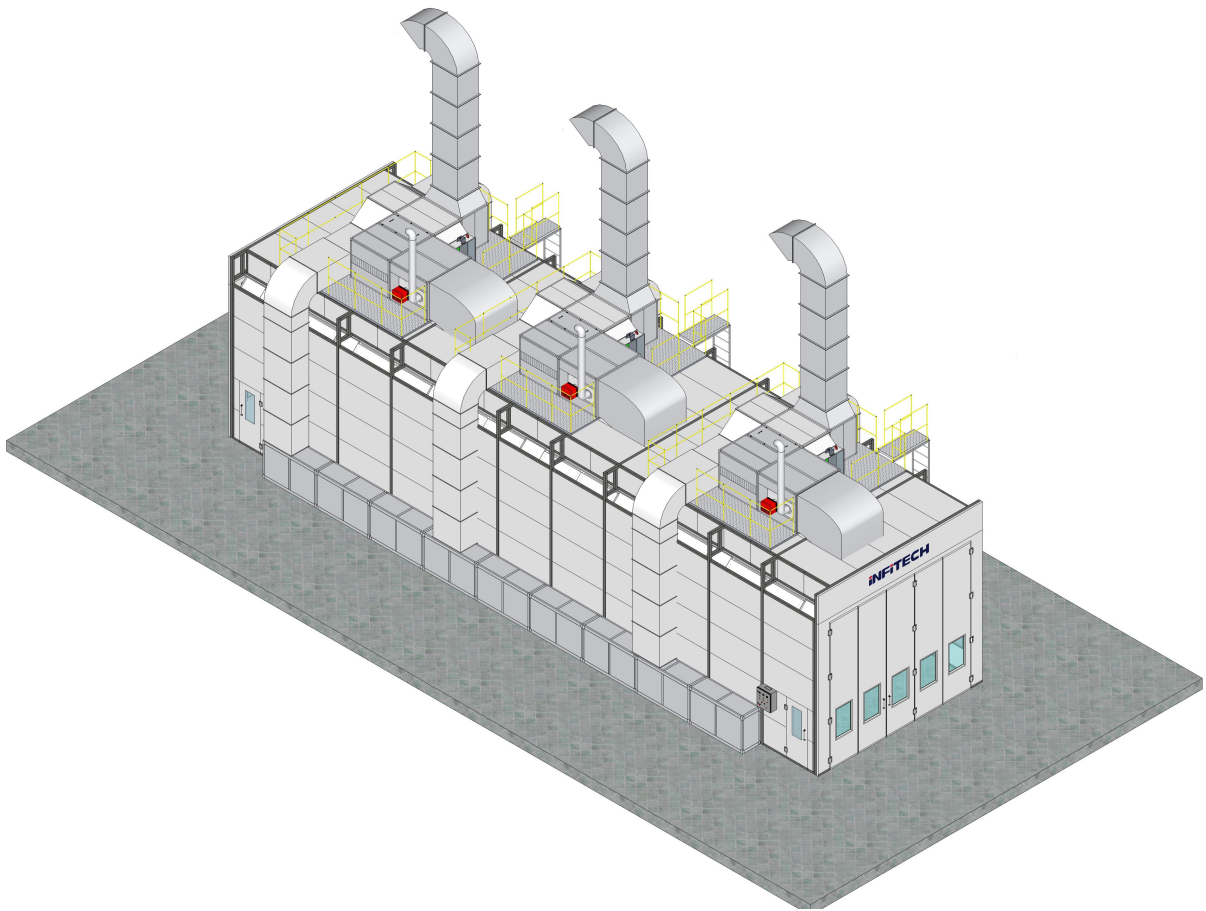

Address: No.2, TaiGang Road, BaiYun District, Guangzhou, Guangdong, China

Phone: +86 - 20 - 36051789

Fax: +86 - 20 - 36051797

Email: fengyin@gz-infitech.com

Web: www.yft-spraybooth.com

QUOTATION

1) PRODUCT AND PRICE

Quotation date: 24-Feb-2018

NO.	Name	Model	Unit	Quantity	Unit price	Total price
1	Spray booth(22X6X5m)	IT-22-6A	set	1	53790	53790
Total EXW price (USD)						53790

2) PRICE TERMS

- Terms of payment: T/T 50% of total value upon order confirmation, balance before shipment.
- Production lead time: 45 days after receiving the advance payment.
- Two-year warranty for main components, excluding the consumables.
- Loading situation: 2X40HQ+1X20GP containers.

Design

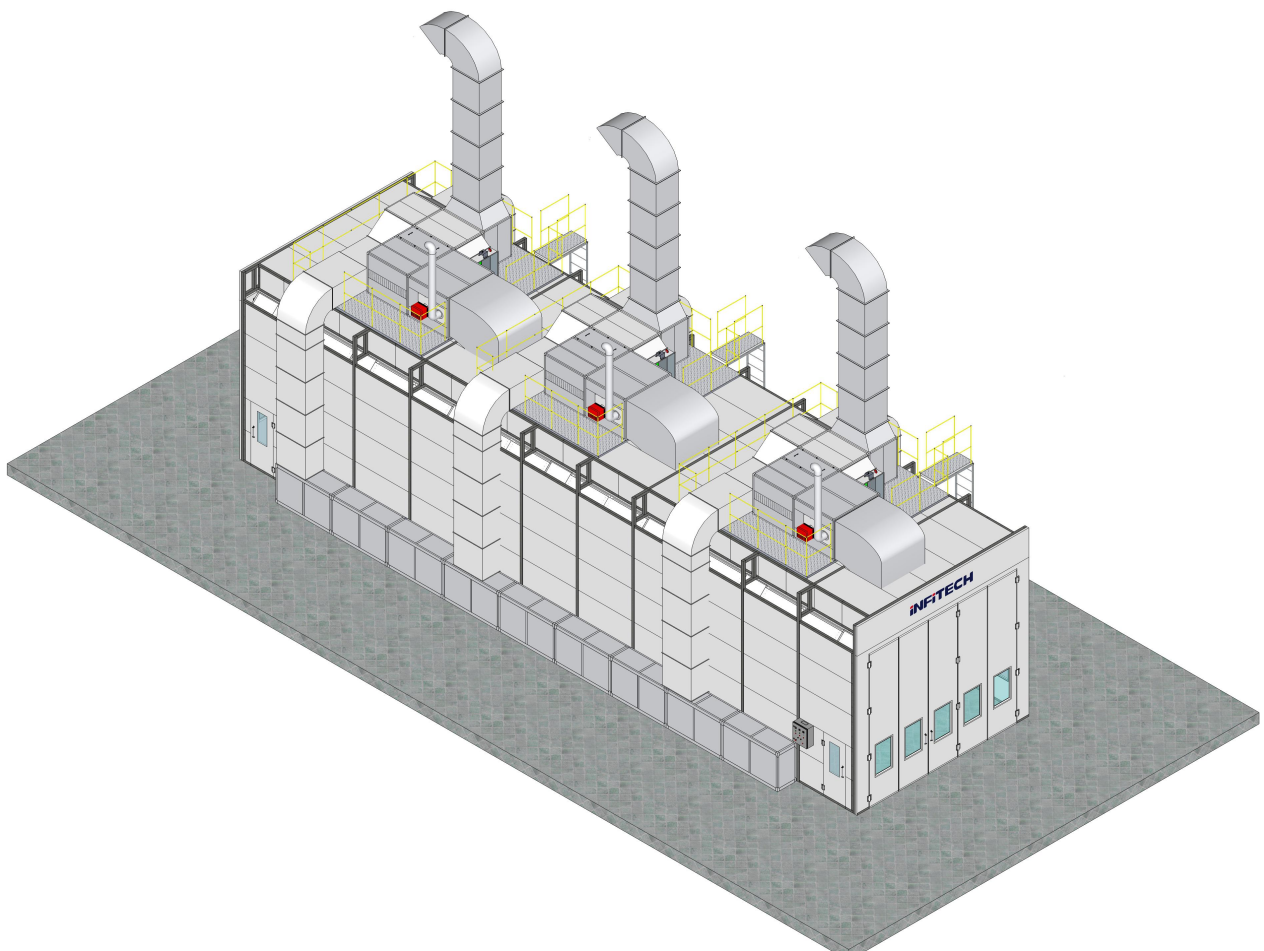
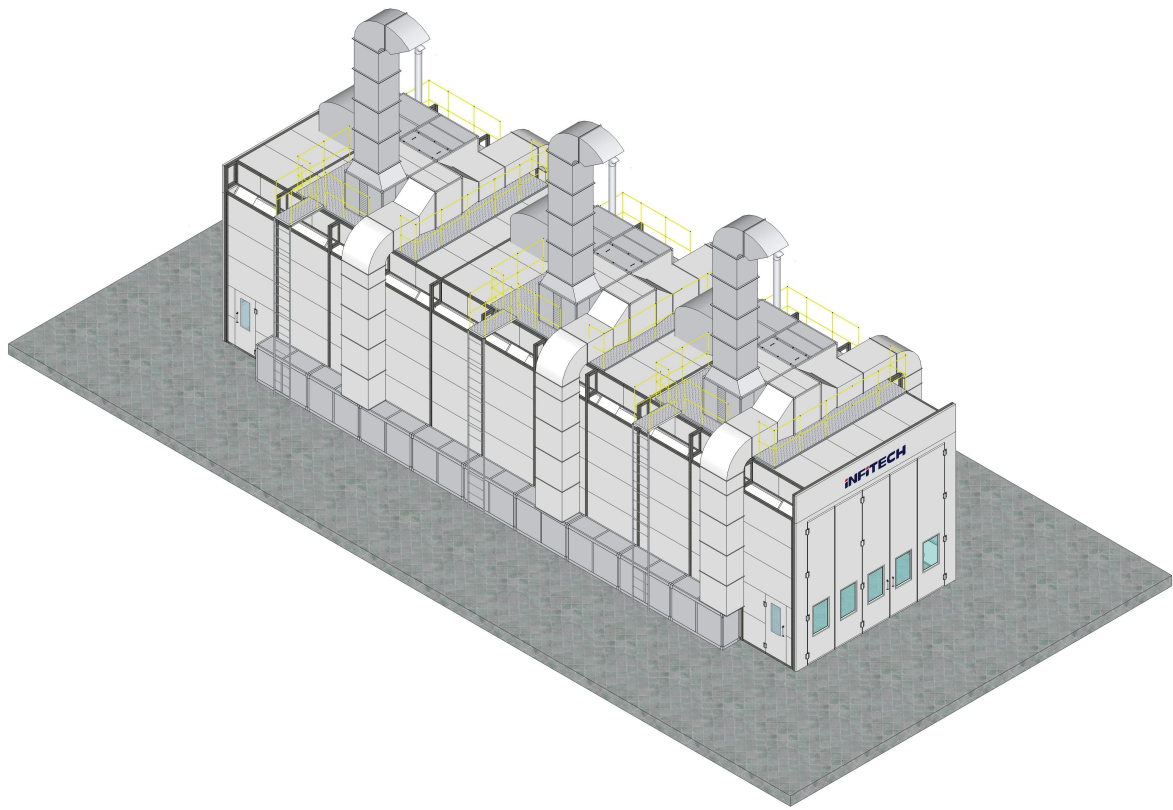

Design

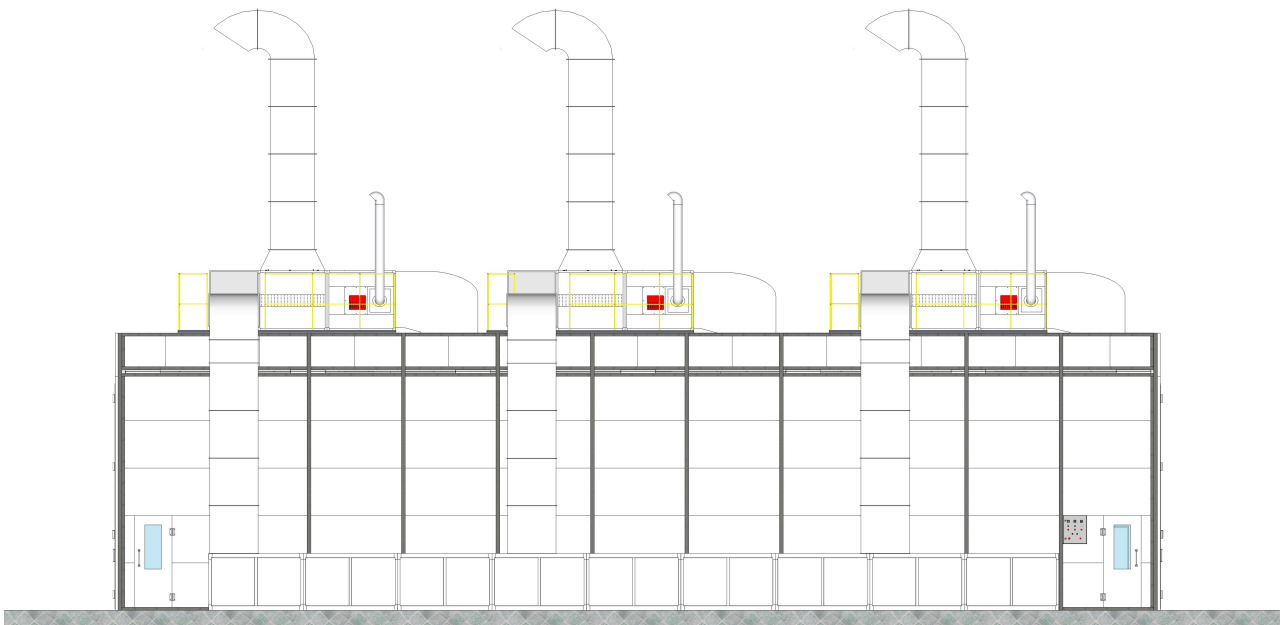
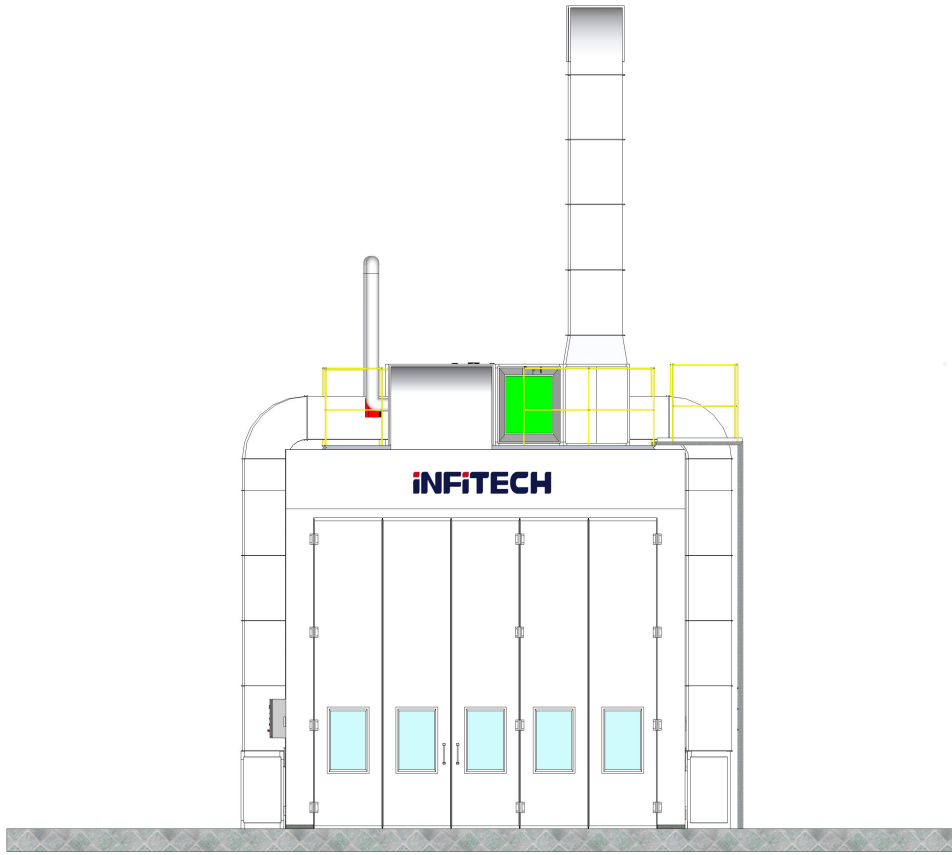

Design

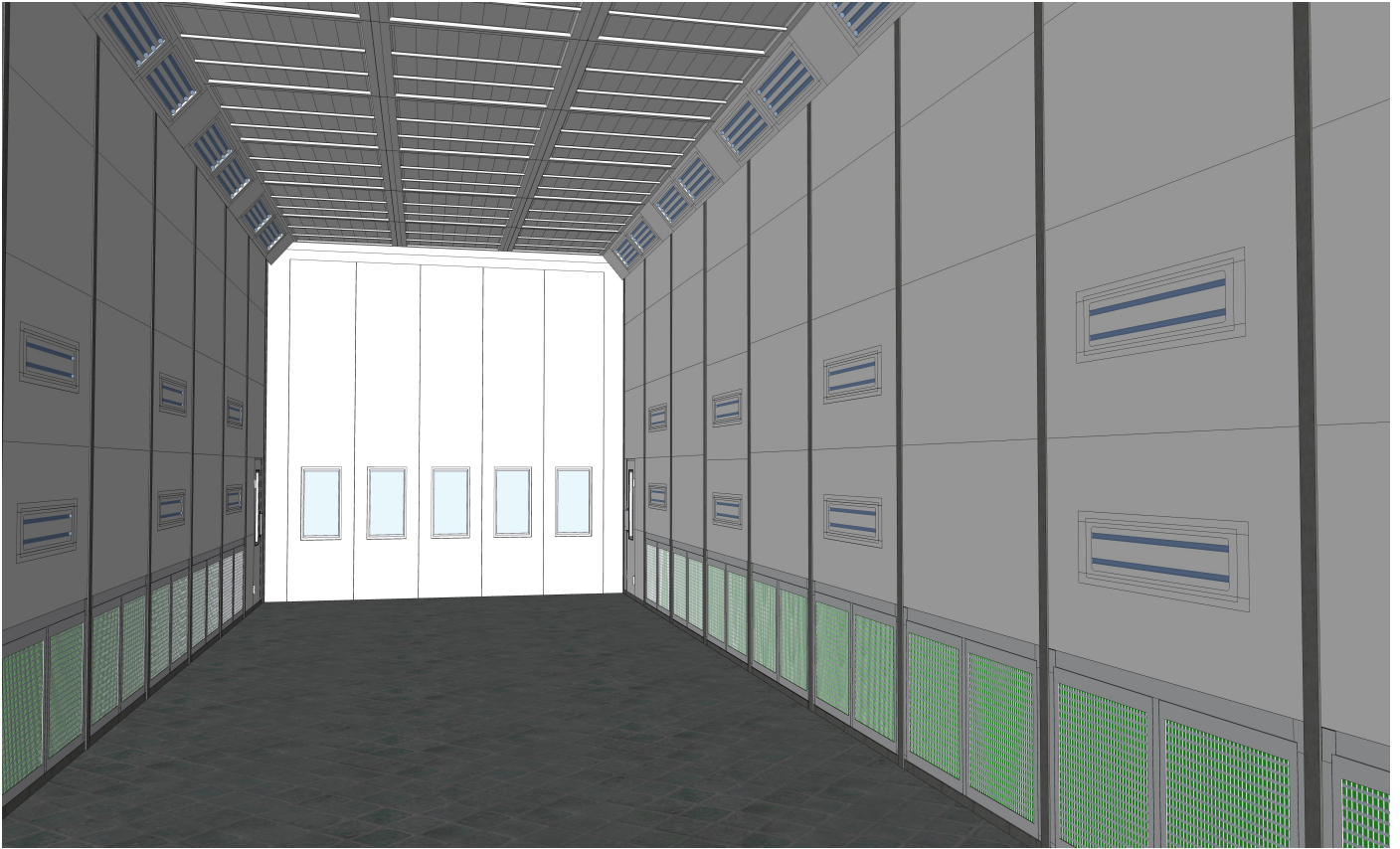
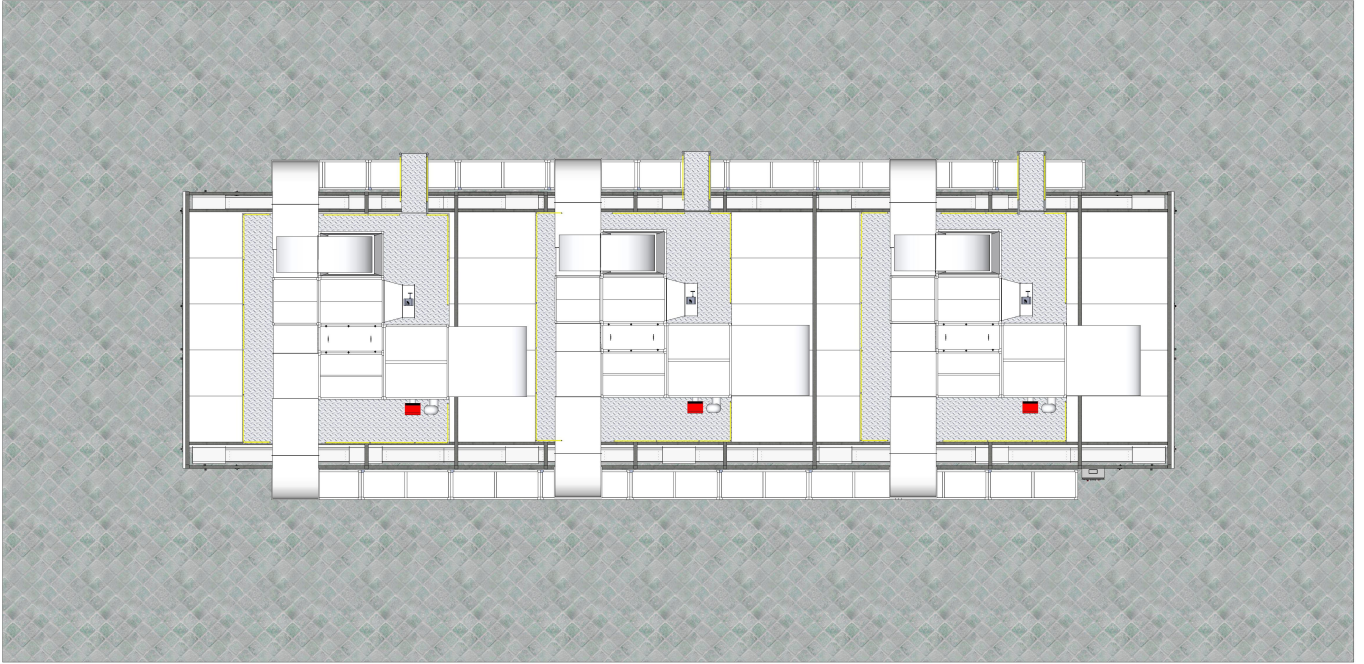

Product: IT-22-6A
Basic information

DESIGN STANDARD	BS EN 13355: 2004 + A1: 2009 BS EN 60204: 2006 + A1: 2009
BOOTH DIMENSIONS	
Internal dimensions	22000 X 6000 X 5000mm (L X WX H)
External dimensions	22160 X 7320 X 7500mm (L X WX H)
BASEMENT	
Basement design type	No base, with two rows of air exhaust plenums
Air extraction type	Side down draft extraction type
Air exhaust plenums	Frame structure, size: 1920 X 660 X1200mm (L X B X H)
Filtration area	43m ²
CABIN	
Cabin structure	80 x80 3.0 thick square tube frame, gantry structure Wall panel horizontal insert
Plenum height	800mm
WALL PANEL	
Wall panel	60mm dual-skin insulated panels filled with heat resistant rock wool
Top material	50mm dual-skin insulated panels filled with heat resistant rock wool
Edge material	1.2mm galvanized plate bending forming
ENTRANCE DOOR	
Form	Manual door, 4 wing entry door (3+2 structure)
Size	4750 X 4800mm (W X H)
Quantity	Product entry door, 2 set
Door description	Containing frame, with safety glass observation window
PERSONNEL DOOR	
Form	Frame structure
Size	800 X 2000 mm (W X H)
Quantity	4 sets
Door description	With safety glass observation windows
SIDEWALL LIGHTING	(LED lamp)
Quantity and power	20 sets of light fixtures, each 4 X 18W, total 1440W
Lighting arrangement	On both sides
Lighting description	Protection grade IP55
CEILING LIGHTING	(LED lamp)
Quantity and power	30 sets of light fixtures, each 4 X 18W, total 2160W
Lighting arrangement	On both sides
Lighting description	Protection grade IP55
Brightness	> 800Lux
FILTRATION SYSTEM	
Pre-filtration	G3 grade pre-filter bag filter
Ceiling filter	F5 class filter cotton, Model SP-600G
Floor filtration	Pleated andreae filters + Fiberglass paint arrestor filters

Exhaust filtration	Activated carbon filter mat, M style
INTAKE SYSTEM	
Intake fan	Direct-type turbine fan
Intake fan power and motor description	3 X11KW, 970rpm, 380V, 50Hz, CE
Parameter of intake fan	3 X 35,000m ³ /h, 650pa
EXHAUST SYSTEM	
Exhaust fan	Direct-type turbine fan
Exhaust fan power and motor description	3X11KW, 970rpm, 380V, 50Hz, CE
Parameter of exhaust fan	3 X 35,000m ³ /h, 650pa
Equipment empty loaded air speed	+/- 0.22m/s
NOISE	<78db
HEATING SYSTEM	
Heating exchanger material	Stainless steel 1Gr18Ni9Ti(SUS304)
Heating exchanger capacity	3X 232KW(260.000Kcal/H)
△T temperature increase ability	25° C (from -5°C to 20°C, in painting phase)
Maximum working temperature	80° C
Burner Model	RIELLO RG5D X 3
Heating Time	15-25 minutes (from 20° C to 60° C) in baking phase
DUCTWORK	
Straight ducting	12 pieces
90° elbow	6 pieces
Reducers	6 pieces
Manual damper/ Electric damper	3 pieces/3 pieces
CONTROL SYSTEM	
Implementation standards	Standard Y/Δ drop starting control system
PLC programmable logic controller	PLC control, higher reliability, lower failure rate
Pressure detection	Pressure gauge indicates pressure inside the booth.
Power distribution facilities	CE standard electric cable, terminal box, wiring tubes and accessories
Features	Painting, heating painting, flash-off, baking, emergency stop switch, failure indication, baking delay stop protection, motor over-load and over-current protection, over-temperature alarm indication, fan and heating system interlock control
OPTIONAL	
■ 3 axis lifter with platform	It allows painter to reach all around the workpiece, greatly increase efficiency and save labor cost.
■ Inverter control	Inverter control, energy-saving, more economical
■ Touch screen control system	Touch screen control, easier to operate
■ Fire-proof rolling shutter door	
■ Plate roll-up door	
SPECIAL ITEM	Rated power:75KW
■ Overhead steel platform	1set

Detailed information

● Cabin structure

There is reinforcement structure outside the cabin. The reinforcement is “Π” beam consisting of 80 x 80 square tubes. “Π” beams are distributed evenly along the cabin, and linked and reinforced by 80 x 80 or 80 x 40 square tubes, ensuring the overall strength of the cabin. All metal structures are applied with corrosion protection treatment. The first step is sand-blasting and de-rusting. Then they are coated with anti-corrosion and weatherability primer and topcoat, making the metal structures aesthetic and durable. The strength, rigidity, stability, thermal insulation property, tightness, impact resistance and earthquake resistance of the cabin has met industry standards, salt-fog resistance ≤ 500 h.

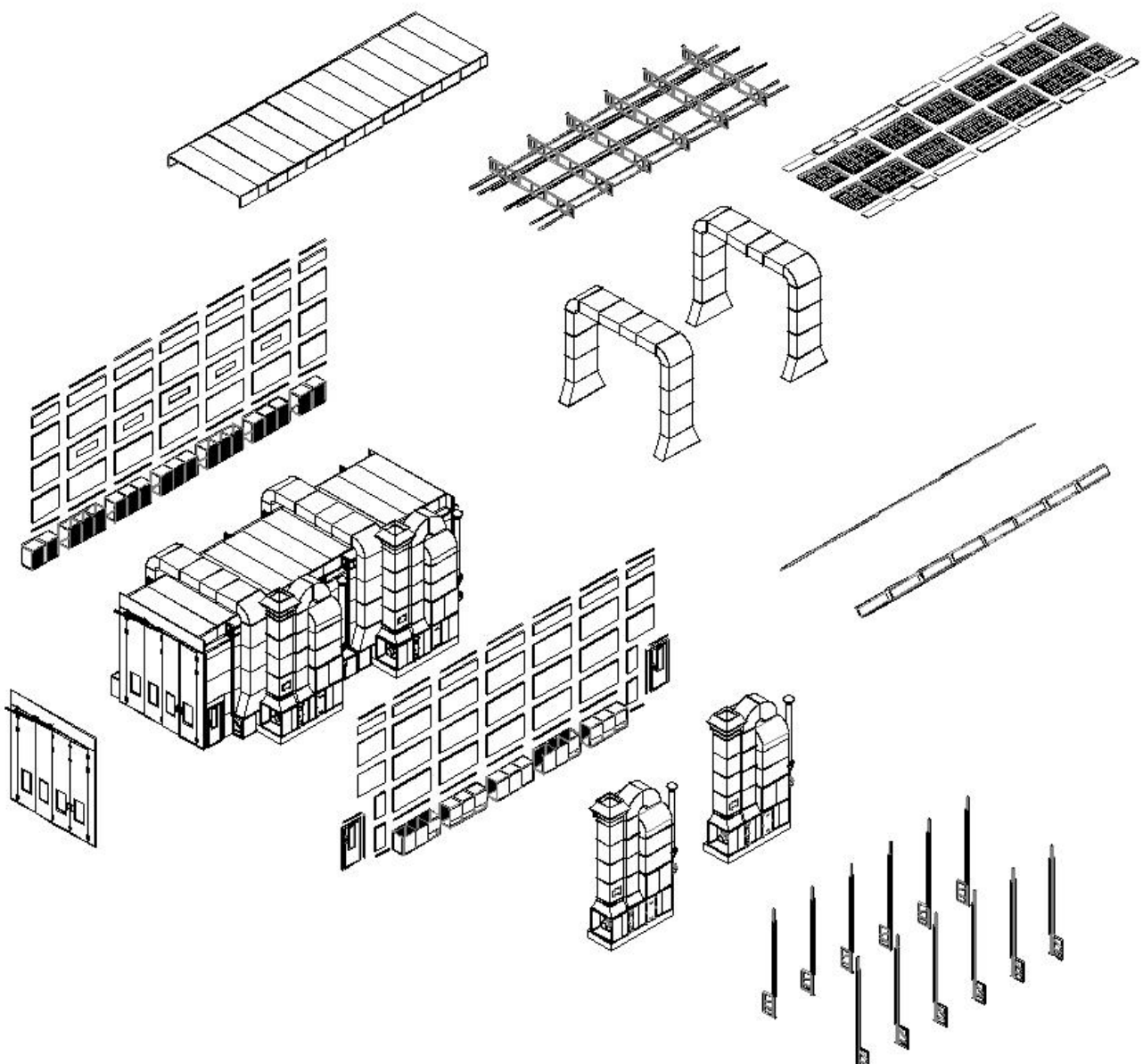

● Airflow system

Air enters the booth through the 800mm high plenum, the wide space of which allows for less static pressure and even air distribution from the plenum to the cabin. Then air flows downward over the work-piece. When air reaches the floor, it is pulled into floor-level filtered exhaust plenums on each side of the booth.

Diffusion device is equipped at the ceiling plenum, providing important assistance to balance the airflow in the plenum.

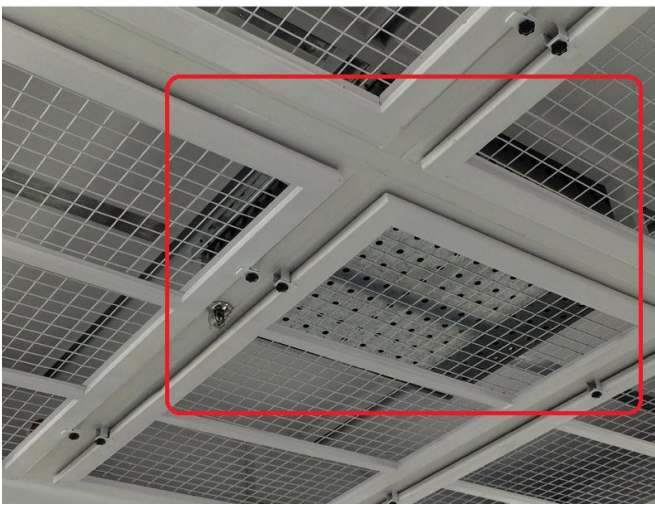

● Entrance door

- 5-wing entry doors with durable rubber for airtight seal
- 0.6mm thick white colored steel plate
- With tempered observation window on all doors
- Heavy duty handles, latches and hinges for years of reliability
- Equipped with anti-sagging means to prevent the doors from falling down

Door size: 4750 X 4800MM (BXH) observation window size: 1000X500MM (BXH)



● Rock Wool Board

- Wall panels: White powder coated dual-skin insulated panels filled with 80KG/m³ rock wool, total thickness: 60mm, substrate thickness: 0.426mm
- Top panels: White powder coated dual-skin insulated panels filled with 80KG/m³ rock wool, total thickness: 50mm, substrate thickness: 0.426mm

The booth panels are made of galvanized sheet steel that is primed and powder coated on both sides. In order to protect panels from scratches during shipment, a clear PVC plastic sheet is applied on the surface of each panel before shipping. This plastic sheet can be easily removed after the construction of the booth.

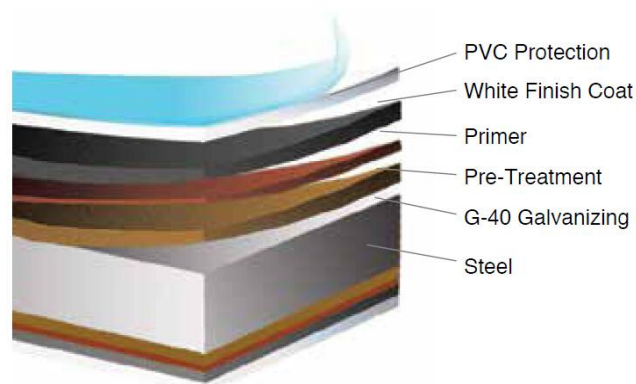

Groove and tongue construction design facilitates easy booth setup.



● Two rows of air exhaust plenums

Size: 18000 X 660 X1200MM (L X B X H)

Arrangement: on both sides of the cabin

- Made from high quality galvanized steel plate, anti-corrosion capacity: over 20 years
- Assembly structure
- With pleated andreae filters + fiberglass paint arrestor filter, paint holding capacity: 3.5KG/m³

The below pictures show finished effect for reference.



● Lighting system

- Money saving energy efficient T-8 fixtures
- Sealed fixtures fitted with tempered glass
- IP55 protection grade, light fixtures fully meet EU standards
- 45 degree angled ceiling lights + horizontal sidewall lights create virtually shadow-free environment



ILLUMINATION >1000 Lux, the lamps are as per following:

Equipment	Item	Spec.	Qty	Power
Spray Booth	Ceiling Lamp	4 x 18W	20	1440W
	Wall Lamp	4 x 18W	30	2160W
TOTAL CONSUMPTION: 2736W				

● **Filtration system**

- **Inlet Filter—Bag filter**

This is a double-filtering system for the fresh air which is driven by the ventilation-in and ventilation-ex fan simultaneously during painting process and introduced to the operation area. The first filtering device is placed to keep dust off the fresh air to prevent dust from contacting with the ventilation-in fan, which provides longest durability/functionality for the fan(s).

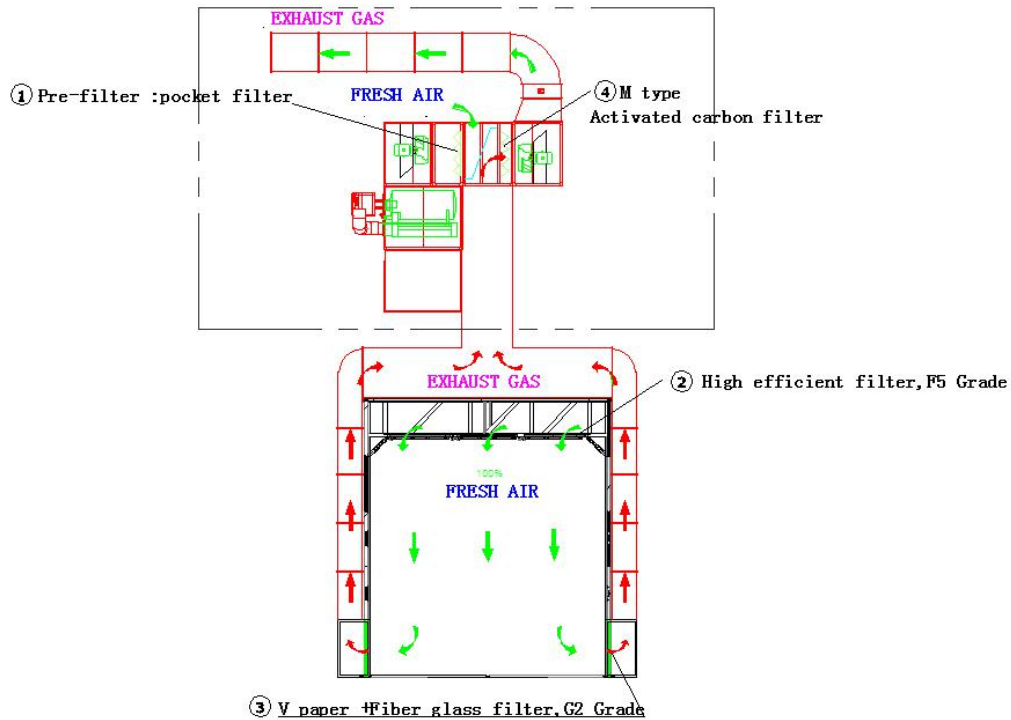

- **Micro-dust Filter—High efficiency SP-600G**

The second filtering system is placed at the chamber's ceiling to keep off 100% of 10µm micro-dust, 96% of 5µm micro-dust, and 20% of 1µm micro-dust, which creates superb condition for high quality result of surface coating.

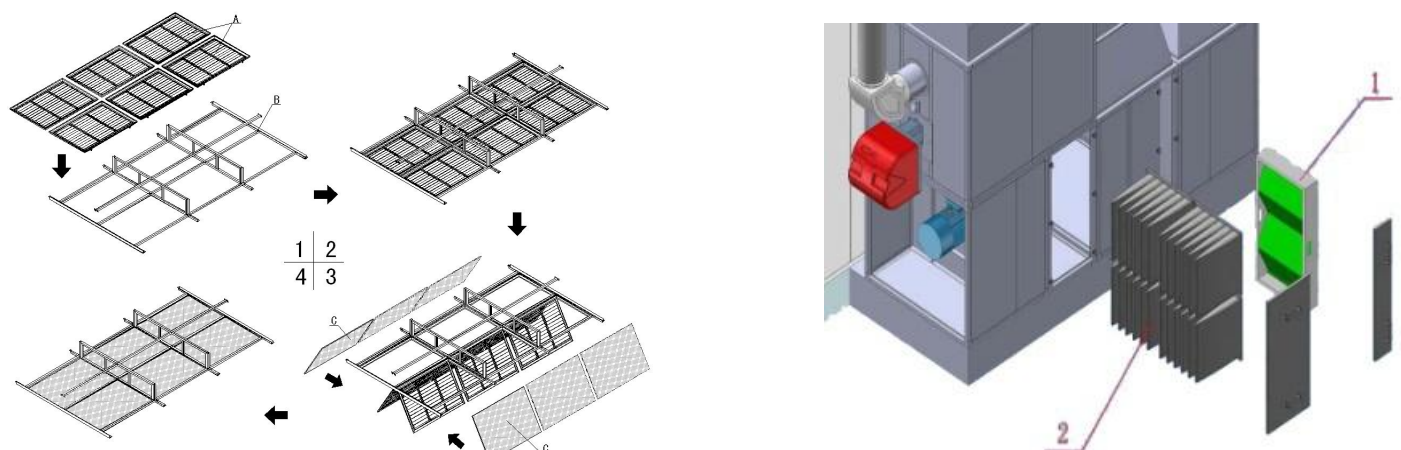

It is very important to guarantee large area for the filters to purify the incoming and outgoing air, maintain suitable air flow without turbulence in the booth to achieve quality result for the painted surface, and cure the wasted air before it is discharged to the atmosphere. Even though the machine applies big-area filter, the maintenance of replacing filters is designed to, and can be handled easily by one man.

Item	Specification
Inlet filter	Bag filter
Micro-dust filter	High efficiency SP-600G
Floor filter	Pleated andreae filter + Fiberglass paint arrestor filter
Exhaust filter	Activated carbon filter mat, M type

Clips & Hinged filter racks facilitate quick and tool-free filter replacement, improve efficiency and save labor cost
(The ceiling filter can be changed within 20 minutes, and can be completed by one man.)

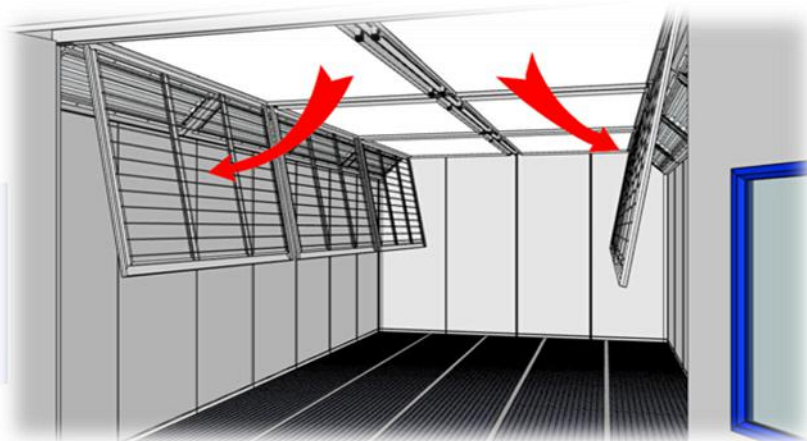

● Intake & Exhaust system

- Non-spark fan design perfectly conforms to EN13355-2004 requirements for the fans.
- Motor and fan are completely separated, meeting the compulsory requirement for fans in EN13355-2004.
- Adopting cylinder-drive paint-bake conversion damper, more quickly and accurately.
- Direct-drive fans, virtually maintenance-free.

Intake / Exhaust Motor	Intake / Exhaust Fan	Air Volume	Drying system
3 x 11KW, CE	IT850 backward centrifugal fan, direct linkage	3 X 35,000m ³ /h	3 X 232KW



● Heating system

- Heating exchange rate reaches 85%, heating time is 15-25 min after burning.
- Adopt EU standards, three-circulation duct design with high safety and maintainability, energy-saving.

Heating system	
Heat exchanger materials	Stainless steel 1Gr18Ni9Ti(SUS304)
Heat exchanger capacity	3 X 232KW
ΔT Temperature increase ability	25°C (from -5°C to 20°C in painting phase)
Maximum working temperature	80°C
Heating time	15-25 minutes (from 20° to 60°C in baking phase and after burner works)
Burner model	RIELLO RG5D X 3

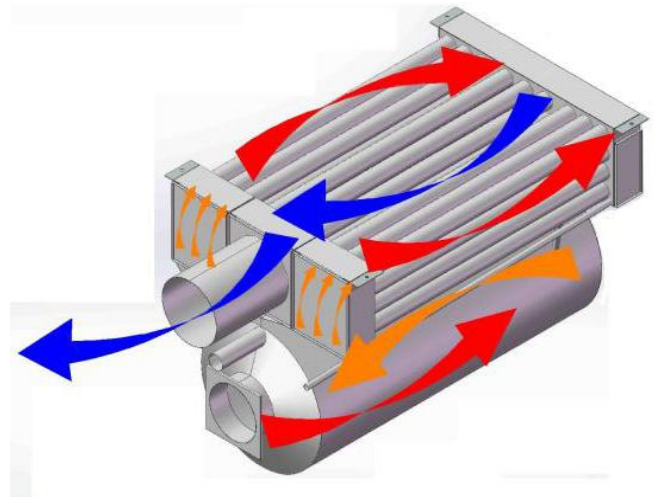

● Control Board

- Control board conforms to EN60204-1-2006;
- Control order conforms to EN13355-2004;
- Control box conforms to IP55 protection grade.



Functions:

- Fully automatic spray, bake, and cooling cycle
- Standard Y/Δ drop step-down start control system
- Over-temperature protection
- Motor overload and over-current protection
- Lights shut down automatically when baking
- Automatic control of the temperature and time
- Emergency stop switch
- Hour meter
- Magnehelic workspace pressure display

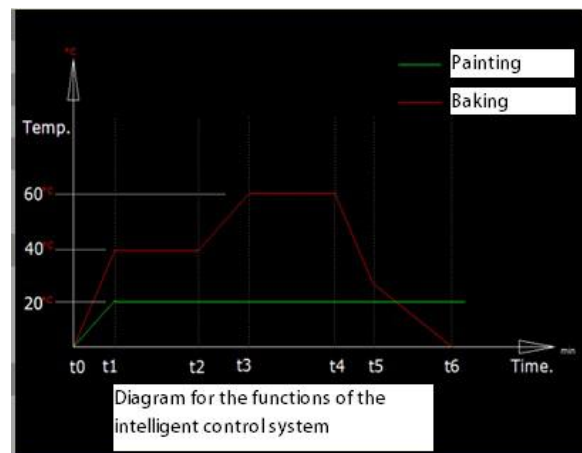

Components:

- The electric components comply with CE requirements
- Wire diameter, colors, and terminals comply with CE requirements
- Siemens brand for main electric components
- 2-year warranty for the electric components

● Overhead steel platform (Optional)

- Modular design
- Consists of support column, steel platform frame, skid-proof diamond plate, protective guard, and maintenance ladder etc.
- The steel platform is connected by 8.8 screw bolts and it is convenient to install.
- All metal structures are applied with corrosion protection treatment. The first step is sand-blasting and de-rusting. Then they are coated with anti-corrosion and weatherability primer and topcoat, making the metal structures aesthetic and durable.
- The strength, stability, thermal insulation property, impact resistance and earthquake resistance of the cabin has met industry standards, salt-fog resistance ≤ 500 h.

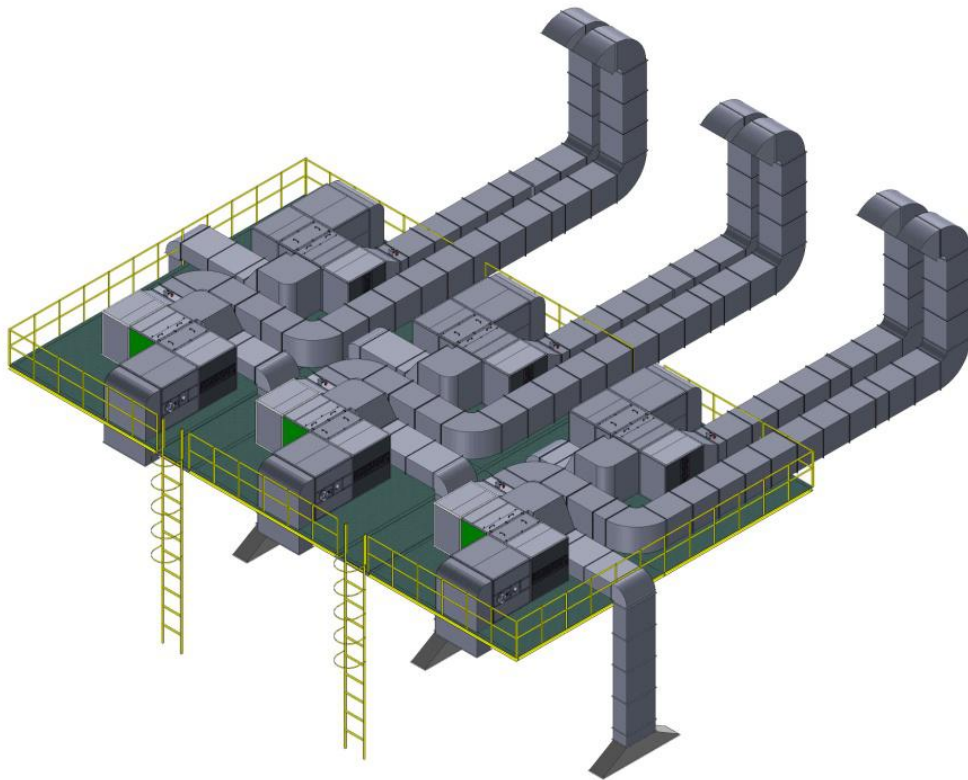

● 3 axis lifter with platform (Optional)

Increase your efficiency and save on labor costs by adding this critical tool to your paint booth. 3-axis lifter with platform allows painter to reach all around buses/trucks and large work-pieces by using joysticks instead of positioning ladders and moving tools up and down. Cut prep time in half, cut masking time in half, cut painting time in half with 3-axis lift in your paint booth.

- Three-axis movement, fully reaches all around the work-piece.
- Stable performance, safe and reliable.
- The speed of moving left and right, up and down, in and out can be adjusted by frequency inverter.
- The electric control system of the operating table conforms to anti-explosion requirements.
- Foot switch controls the longitudinal movements, and inching button controls the up and down movements.
- The 3D lift consists of vertical support post, working platform, sliding rail(upper rail, lower rail), lifting system, stretch system and electric control system.
- The lifting capacity is not less than 300kg, moves stably.

3 axis lifter with platform	
Lifting Height	3300mm from floor
Travel distance	14000mm
Travel speed	8m/min
Dimension of the platform	900 X 900mm
Lifting height of the platform	550~3300mm
Speed of moving in and out	3m/min
Lifting capacity of the platform	300KG
Total power	3KW

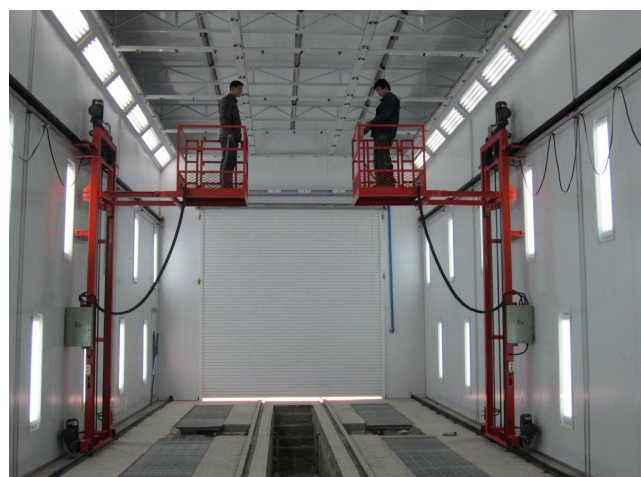

● Inverter Control (Optional)

This circuitry offers the capability to reduce energy consumption to the minimum during breaks in operations or while setting up parts for finishing. The mechanism is triggered when the spray gun is hung up. Minimized exhaust air reduces the energy required for heating the make-up air.

Such circuitry is available in two versions. The first is an economical pneumatic damper control for smaller systems. The second is electrical control of the motors via the switchgear cabinet.

Here is a frequency inverter which is used to regulate the fresh air supply and exhaust fans.

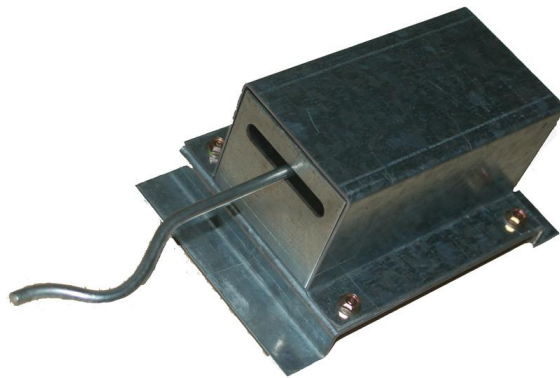

● **Touch screen control system (Optional)**

User friendly interface featuring touch screen and switches, easy to operate



● Fireproof rolling shutter door (Optional)

Door size: 4500 X 4500 mm (B X H)

Galvanized sheet, filled with aluminum silicate cotton;

Motor power: 1.1KW, maximum lifting weight: 2000kg, lifting speed: 0.2m/s.

**Safety protection device**

With photoelectric protection device at the bottom of the door, built-in infrared ray in the sealing strip. The door bounces up immediately once its bottom touches barriers, which helps protect the forklift below the door.

Safety door spindle

Strictly calculated in accordance with the industrial standard, the spindle bending deformation is less than 1/500 of the spindle width. Round pieces welded inside the shaft can effectively avoid the risks caused by fatigue fracture of the outside welding joint.



● Plate roll up door (Optional)

- Door size: 5000 X 5000mm(B X H)
- Door filled with polyurethane foam, with reinforced ribs;
- With observation window;
- Anti-crash protection device: intelligent wireless airbag anti-pressure sensor, when the bottom edge contacts obstacles, the door immediately moves in opposite direction, which provides safety protection for vehicles below the door;
- Anti-sagging device: when the drive mechanism fails, the safety protection device will block the door automatically, preventing the door from falling down.

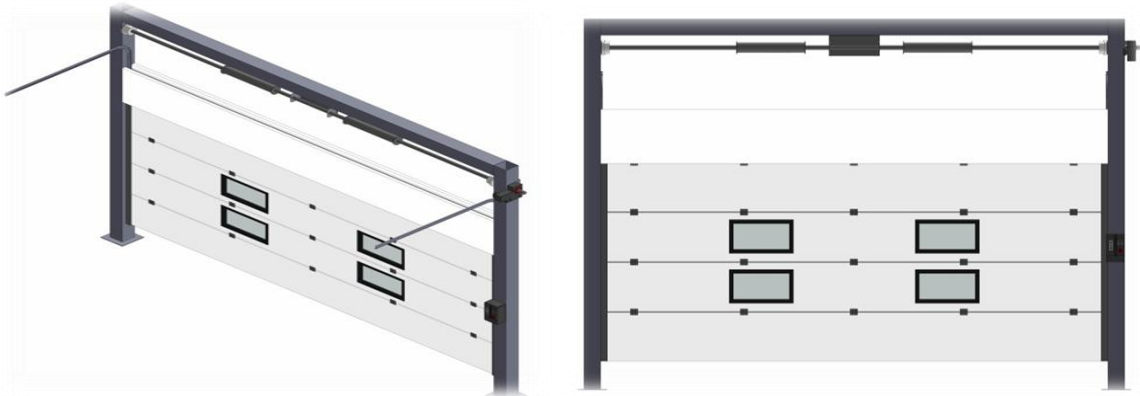

Service & Support

Dedicated, expert, always available, and fast response, INFITECH has made customer service a priority since the very beginning. INFITECH's service does not end after the equipment is sold and shipped. Instead, INFITECH attends to every request/query from the user during the installation, commissioning, operation and maintenance processes.

● Pre-sales & Sales Service

1. Carefully study clients' demands, design & offer products that best suit clients' needs.
2. Offer favorable price, but not at the cost of reducing product performance.
3. Use quality materials of well-known brands to ensure reliability.
4. Inspect product quality before packing and shipping.
5. Seaworthy packing for the goods.

● After-sales Service

➤ Delivery commitment:

1. Comply with the delivery schedule required by clients. If fail to commit, shall inform clients at least 1 week in advance.

➤ After-sales Service Commitment:

1. Supply installation manual, electric schematic, and operation & maintenance manual to help users install, operate and maintain equipment properly.
2. 2-year warranty for main components. Consumables are not within the scope of warranty. INFITECH freely replaces damaged parts caused by quality issues within warranty. Beyond warranty, INFITECH provides spare parts at cost. If the equipment is damaged due to human factors, INFITECH repairs or provides spare parts at cost. Technical support will be provided within 24 hours after receiving the report of the problems.